

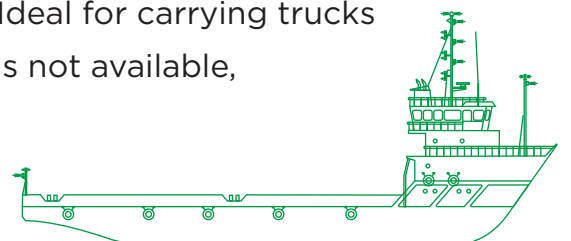

## **SEA BRIDGE MULTIPURPOSE SUPPLY VESSEL WITH FORWARD CARGO RAMP**

A shallow drafted multipurpose supply vessel with a large wooden sheathed deck, good tank capacities for fresh water and fuel, and a forward ramp to accommodate cargoes that can be rolled on and off the stern deck. Ideal for carrying trucks and lorries to and from areas where quayside access is not available, and the only access is a beach.



## DIMENSIONS

Length Overall | 53.8 metres  
Breadth | 13.8 metres  
Depth | 3.8 metres  
Draft Summer | 2.9 metres (Fully Loaded)

## TONNAGE

GRT | 769 tons  
NRT | 231 tons  
DWT | 961.8 tons

## MACHINERY

Main Engines | 2 x Caterpillar 3412  
Horsepower | 2 x 900 = 1,800 BHP  
Main Generators | 2 x Weichai Heavy  
Machinery (installed 2019)  
Power | 2 x 120 Kw  
Bow Thruster | 1 x 224 Kw Cummins with 2.5  
tons Thrust  
Sewage System | 1 x Delta STPN-250 Capacity  
20 Persons  
Air conditioning | Centralised

## CAPACITY

Fuel Oil | 409.3 m<sup>3</sup>  
Cargo Freshwater | 744.5 m<sup>3</sup> (Filtering System)  
Cargo pumps | 1x Fuel oil and 1x for  
Freshwater

## PERFORMANCE

Speed | 10 knots (approx.)  
Fuel | 5.5 tons Per Day Full Speed (approx.)

## CREW

Crew | 18 nos.

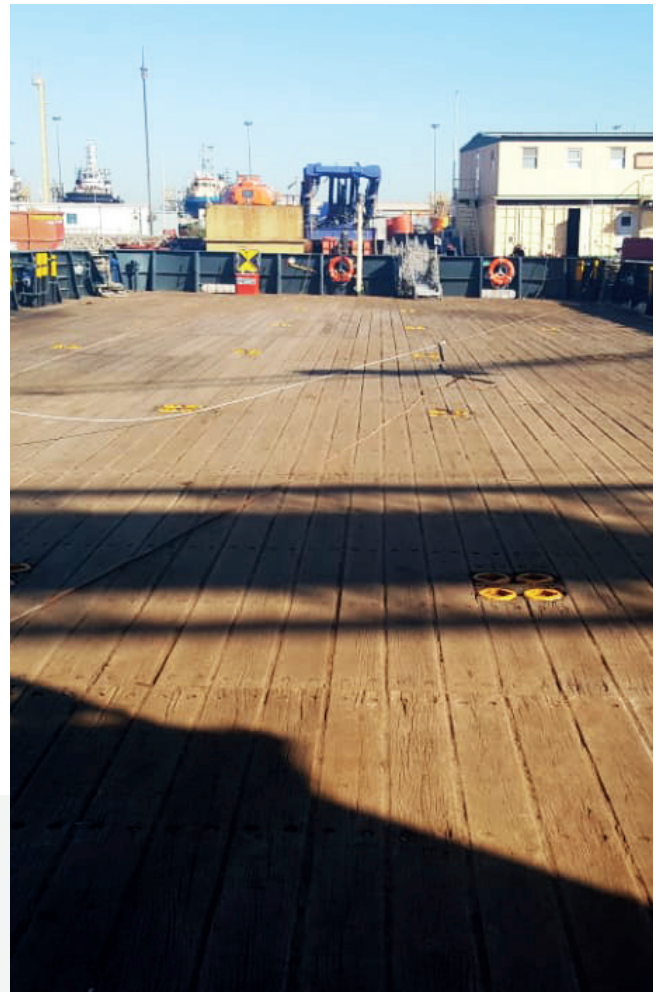

## REGISTRATION

Year Built | 1998  
Builder | Panyu Lingshan Shipyard,  
Guandong, China  
Class | RINA  
Owner | United Offshore Construction and  
Diving Services Ltd  
Manager | Mubarak Marine LLC  
Type | Multipurpose Supply Vessel

## CARGO DECK

Clear Deck Space | 45m x 13.8m = 621 m<sup>2</sup>  
Ramp Passage | 10m x 5m (length x width)  
Dump Track Capacity | 14 to 16 nos.  
Container Capacity | 60 nos. of 20ft.  
containers  
Container Lashing | Fitted

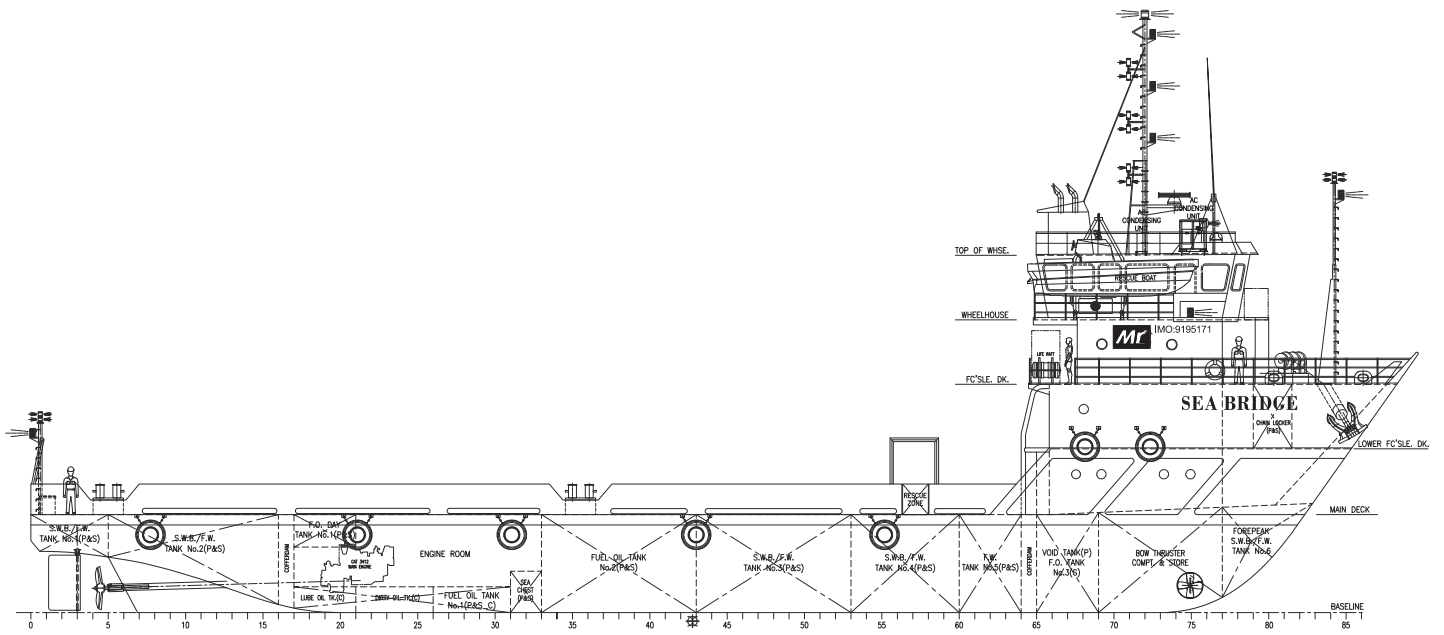

OUTBOARD PROFILE

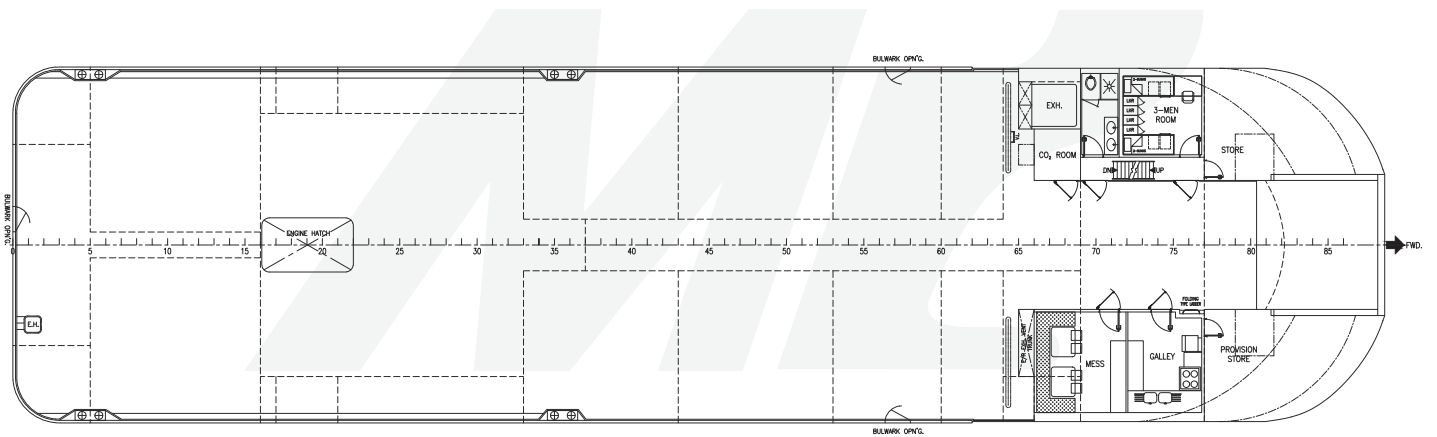

MAIN DECK PLAN

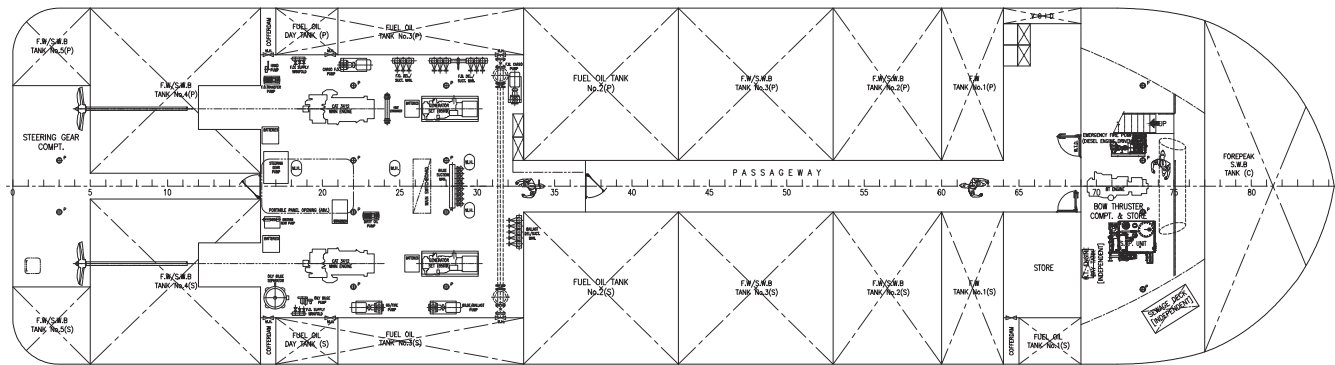

BELOW MAIN DECK PLAN

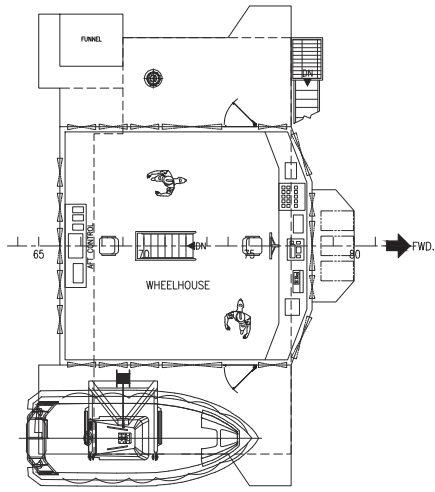

WHEELHOUSE DECK

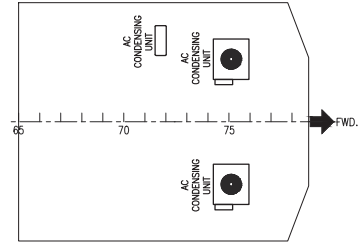

WHEELHOUSE TOP

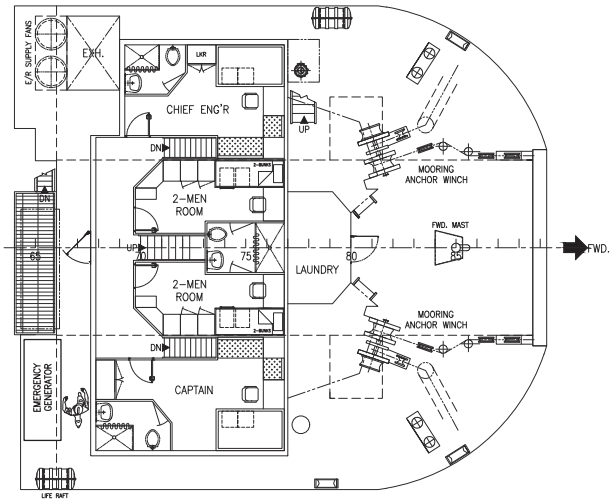

FORECASTLE DECK

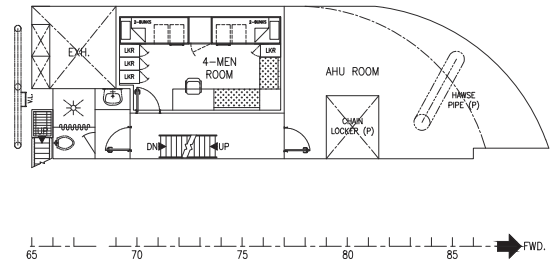

LOWER FORECASTLE DECK

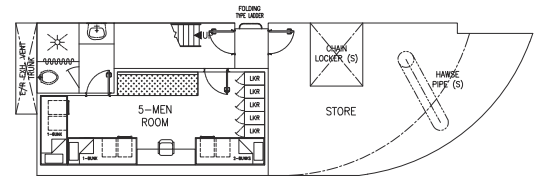

Mubarak Marine LLC | PO Box 7220 | Dubai Maritime City | UAE

T+971 4 586 5200 | F +971 4 586 5299 | marketing@mubarak.ae | mubarakmarine.com

Revision September 2020 | All technical details are provided as a guide only and are subject to owner's changes without notice